

MCCALL'S®

FREE PROJECT

CHAIR SEAT ORGANIZER



SUGGESTED FABRICS:

Fat Quarters; Cotton, Cotton blends, Calico

YOU WILL NEED:

Center Section:

Two Fat Quarters ea. 18" x 22" (46cm x 56cm)

End Sections:

Two Fat Quarters ea. 18" x 22" (46cm x 56cm)

Large Pockets:

One Fat Quarter 18" x 22" (46cm x 56cm)

Small Pockets:

One Fat Quarter 18" x 22" (46cm x 56cm)

NOTIONS:

6½ yds. of single fold Bias Tape

Fusible Interfacing-22" wide, 1⅞ yds.

GENERAL INSTRUCTIONS:

Please read all the instructions before you start your project.

Pin pattern pieces to corresponding fabric sections.

All seam allowances are ⅝" (1.5cm) unless otherwise indicated

CUT FABRIC & INTERFACING:

Center Section: Cut 2, ea. 14" x 19"

End Sections: Cut 4, ea. 10½" x 14"

Large Pockets: Cut 2, ea. 8" x 14"

Small Pockets: Cut 2, ea. 6½" x 14"

1. Fuse INTERFACING to wrong side of each corresponding FABRIC section following manufacturer's instructions.

2. Open out one edge of bias tape. Press.

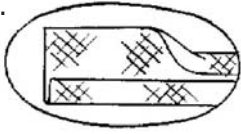

3. Pin this edge to upper edge of POCKET (1), right sides together, having raw edges even. Stitch along crease of tape.

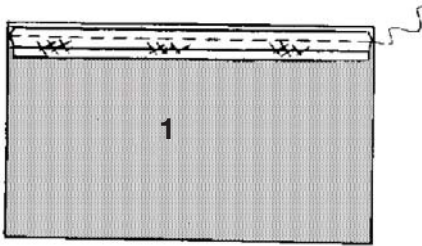

4. Turn tape to inside. Press.

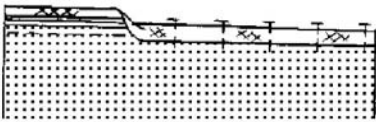

5. On outside, edgestitch close to inner edge of tape, catching all layers.

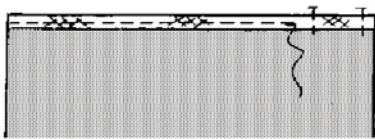

6. Finish upper edge of POCKET (3) in same manner as POCKET (1).

7. With right sides up, pin pocket (3) to pocket (1), Stitch through center (7" from either side).

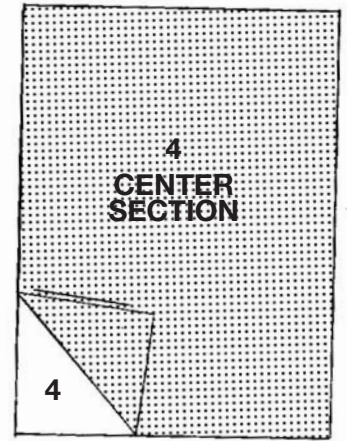
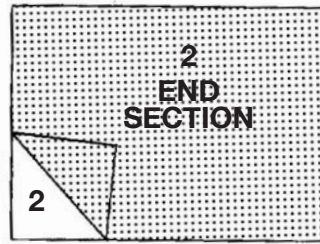
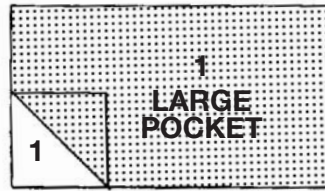
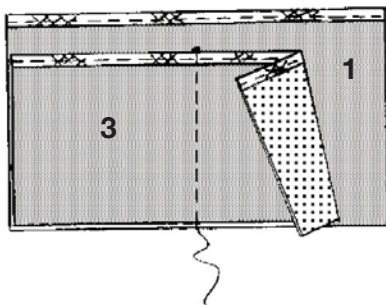

8. With right sides up, pin pockets to interfaced END SECTION (2), Fold back pocket (3) and stitch through pocket (1) 5" from left edge. Baste raw edges together.

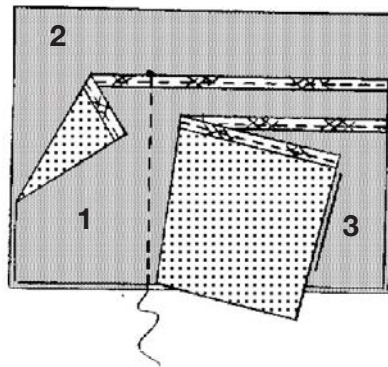

9. Pin CENTER SECTIONS (4), wrong sides together. Baste raw edges.

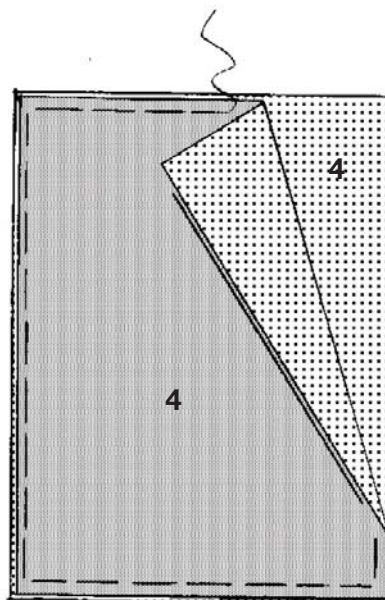

10. With right sides together, pin upper edge of end sections with pockets to center section. Pin remaining end sections to other side of center section, right sides together. Stitch.

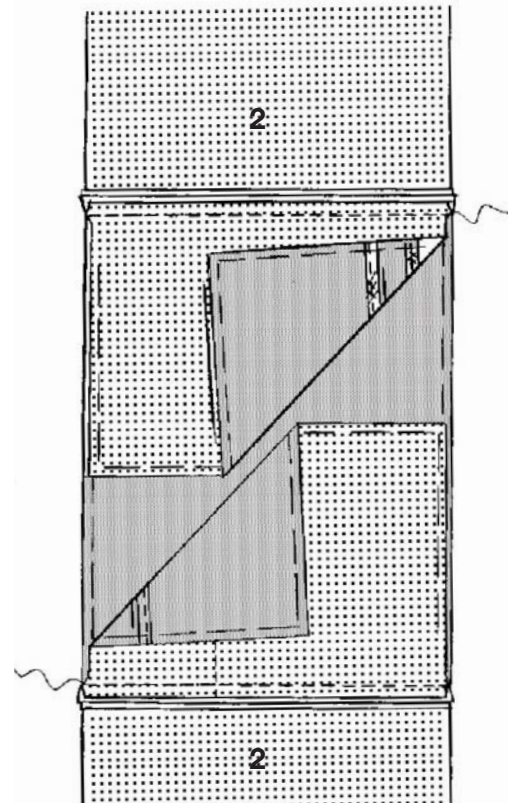

11. Turn end sections, wrong sides together, encasing seam allowance. Press. Baste raw edges together.

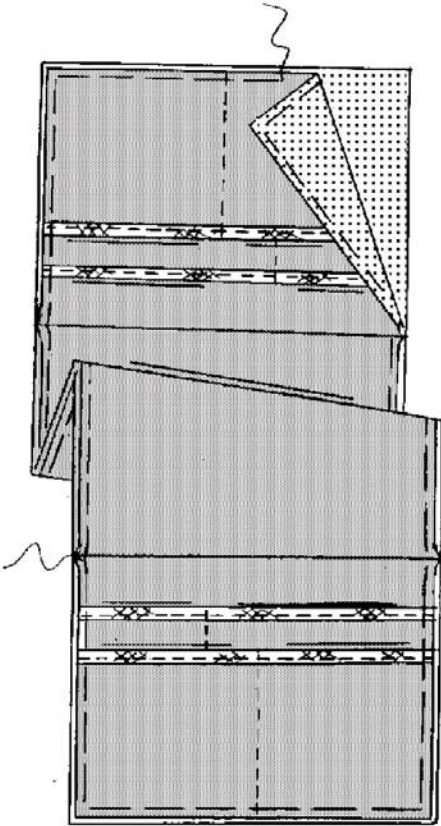

12. Cut a piece of bias tape 60" (152cm) long. Fold tape in half, wrong sides together, having folds even. Edgestitch long folded edges. Cut stitched tape into four 15" (38cm) lengths.



13. On underside of organizer, pin two ties to each seam as shown. Baste across ends.

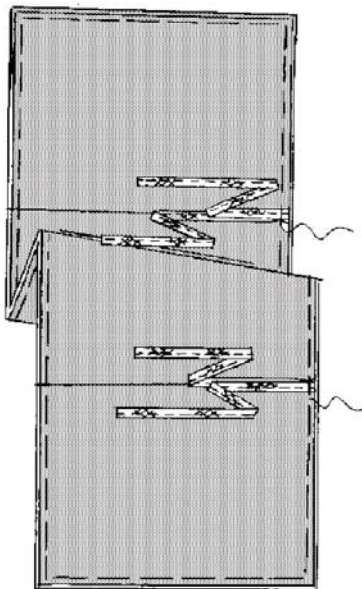

14. Knot each end of tie.

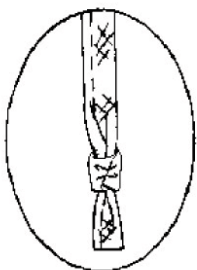

15. Open out one edge of bias tape. Press.

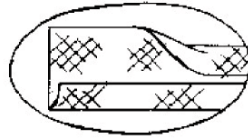

16. With right sides together, pin this edge to outer edge of organizer, having raw edges even, folding in fullness at corners, and turning under one end and lapping over the other at upper edge. Stitch along crease of tape.

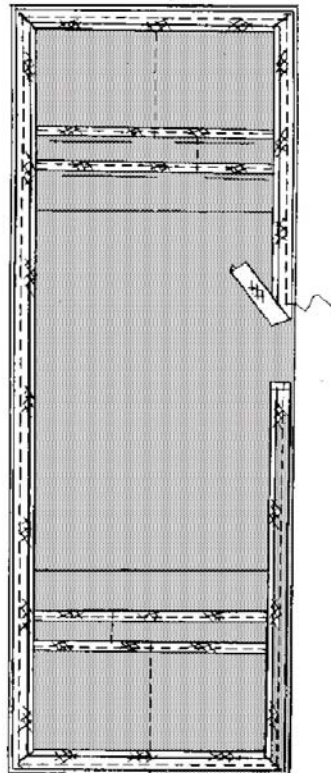

17. Turn tape to underside, folding miters at corners. Press.

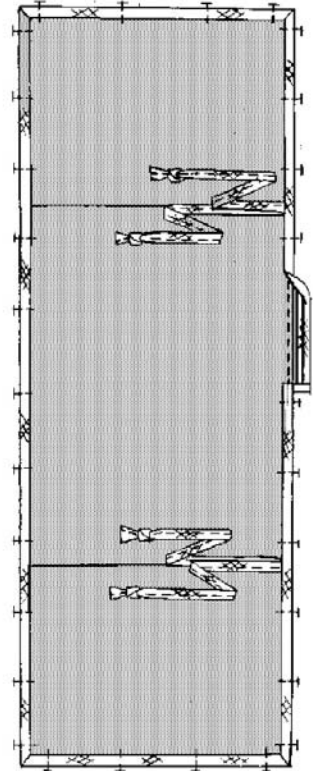

18. On outside, edgestitch inner edge of tape in place, catching all layers.

